

BREL motors is part of:

BREL nederland b.v.

Manual Brel 45mm standard motor

Type MS45

Read the manual before you begin the installation. If these instructions are not followed, this may lead to defects and injury in which warranty can't be claimed.

warning:

Children cannot recognize the dangers of electrical equipment and may therefore not work with it.

It is important to follow this instruction for your own safety.

1. Do not operate the motor in humid surroundings.
2. The motor must be installed correctly.
3. The motor must be protected from direct moisture influences.
4. The motor should be installed with the motor cable down in order to prevent moisture via the motor cable is running in the motor . See Figure 1
5. It is prohibited to connect two motors on a switch without using a relay control.

Figure 1

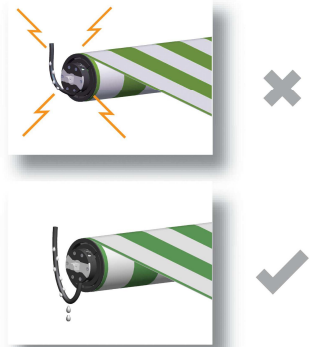
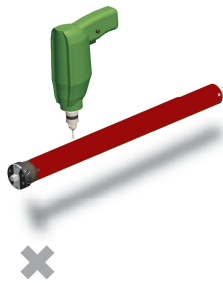

Technical data of the motor

Type MS45-20

Type MS45-40

• Motor Voltage:	AC 230V	AC 230V
• Power:	121Watt	121Watt
• Torque:	20Nm	40Nm
• Speed:	15rpm	15rpm
• Ampèrage:	0.53A	0.53A
• Moisture and dust:	IP44	IP44
• Working temperature of the motor:		
○ Normal use:	-10°C tot +40°C	
○ Heavy use:	-20°C tot +70°C	



Installing the motor

Attach the crown and wheel to the motor and place the clip on the shaft of the motor so that the wheel is fixed to the motor.

Install the motor with the motorbracket on the product and take care that it is secured.

Place the motor in the tube of the roller/shutter.

(These assemblies are usually already done in the factory)

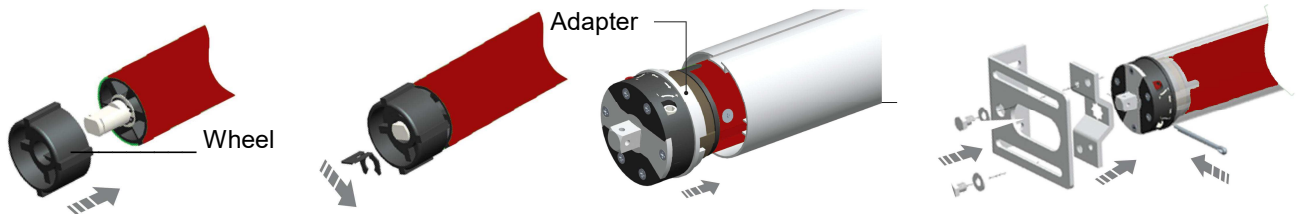

Setting the end limits of the motor

To determine where the motor must stop, you must use the supplied adjustment pin.

The large arrow indicates in which direction you change the end limits.



By turning to the Plus or Minus you can change the end limits.
By turning to the Plus, the motor will make more rotations.
By turning to the Minus, the motor will make less rotations.



The setting needs to be done for both directions of rotation.

If the motor is stopped by it selves, do not make more than one rotation to the minus.

This can disrupt the adjustment.