

BREL motors is part of:



Manual Brel curtaintrack motor

Type MGLE-45

Read the manual before you begin the installation. If these instructions are not followed, this may lead to defects and injury in which warranty can't be claimed.

warning:

Children cannot recognize the dangers of electrical equipment and may therefore not work with it.

It is important to follow this instruction for your own safety.

1. Do not operate the motor in humid surroundings.
2. The motor must be installed correctly.
3. Keep the antenna in a good condition and do not shorten. The antenna should not come into contact with other metal parts otherwise it will reduce the effect.
4. The motor must be protected from direct moisture influences.

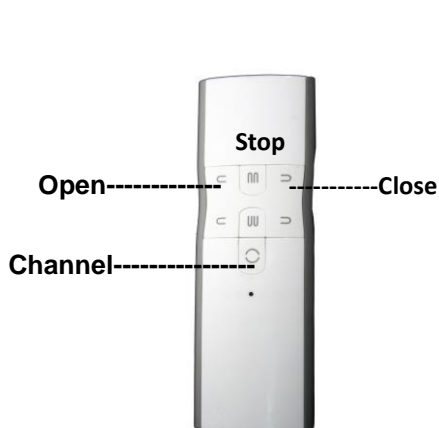

(This is a 2-channel transmitter, two P2 keys for each one channel)

Technical data of the motor

• Motor Voltage:	230V
• Power:	45 Watt
• Speed:	20 cm/sec
• Max. curtain weight:	40 kg
• Ampèrage	0.23 A
• Max. duration:	4 min.
• Moisture and dust:	IP40
• Working temperature of the motor:	
○ Normal use:	-10°C tot +40°C
○ Heavy use:	-20°C tot +70°C

Type MG45



Functions

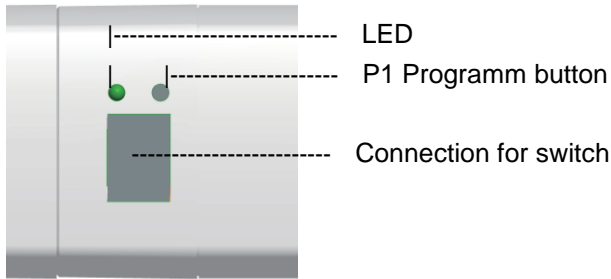

Reach

L1 = 100 meter

L2 = 25 meter

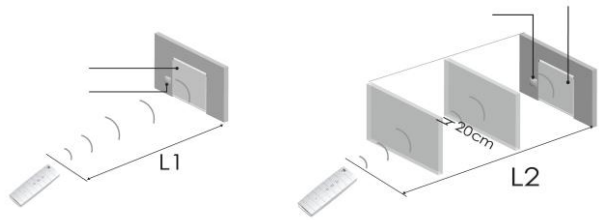

Installation motor and rail

Attach the rail to the wall / ceiling.

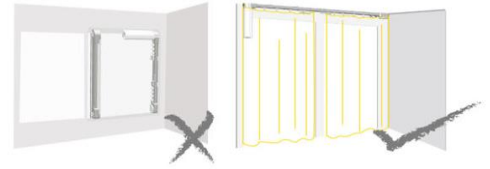
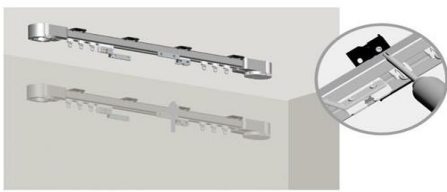

Mount the rail not vertical.

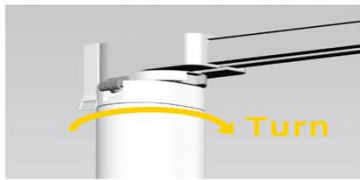

If the motor don't want to click easily, turn the gear wheel a bit and try again.

Charging the battery

When you use the battery for the first time, fully charge it. If the LED on the charger turns green, the battery is full.

Always use the charger type DC-216



Step 1 Setting up the first channel

Option A



Turn the motor on.
The LED flashes.

1x P2



Press 1x on the
P2 button.
The LED flashes.

1x P2



Press 1x on the
P2 button.
The LED flashes 5x.



Press the open or closed button
and the transmitter is ready for use.

Option B

2 sec.



Press 2 sec. on P1.
When LED flashes,
let go.



2x P2



Press 2x on the
P2 button, within
3 sec.



The LED flashes 5x.



Press the open or closed button
and the transmitter is ready for use.

*If the curtain is moving in the wrong direction, repeat the above procedure and then press close.
With the above action deletes all the channels in memory and the final adjustment.*

Step 2 Set or change preset position

If you press the Stop button longer than 3 sec., the motor will move to the preset position from any position.

1x P2



Press 1x the P2
button.



1x STOP



Press 1x stop button.
The LED flashes.



1x STOP



Press 1x stop button.
The LED flashes.



OK

The position has now changed.

To remove the preset position, you must go to the preset position and repeat above action.

Step 3 Delete transmitter

Deleting the transmitter can be done in three ways:

1. When setting up the first channel also the limit setup will be removed.
- 2.



Press P1 button until the LED flashes 2x and blinked 1x.

3.

1x P2



Press P2 button 1x.



1x



Press close button.



1x P2



Press P2 button 1x.



OK

Step 4 Teaching multiple transmitters

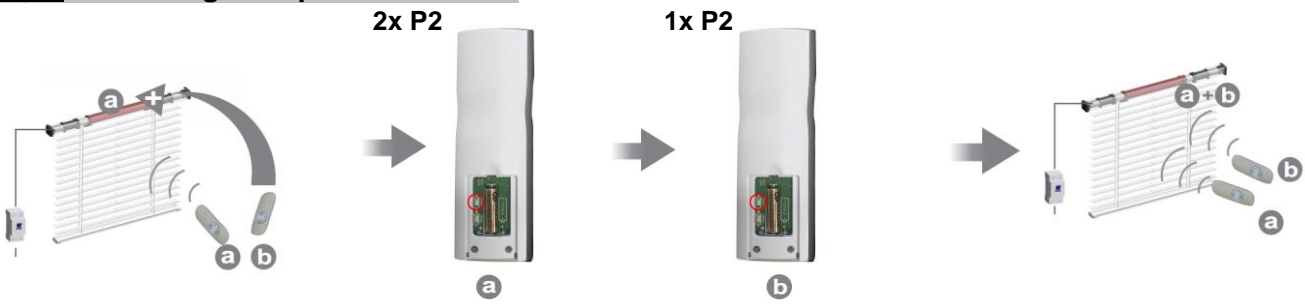

Press P2 button 2x of the existing transmitter. a

Press P2 button 1x of the new transmitter or channel. b

Programming the new transmitter is ready.

To delete one channel , you must repeat the above operation.

Step 5 Setting the switch

