

BREL motors is part of:



Manual Brel curtaintrack motor

Type MG-45

Read the manual before you begin the installation. If these instructions are not followed, this may lead to defects and injury in which warranty can't be claimed.

warning:

Children cannot recognize the dangers of electrical equipment and may therefore not work with it.

It is important to follow this instruction for your own safety.

1. Do not operate the motor in humid surroundings.
2. The motor must be installed correctly.
3. Keep the antenna in a good condition and do not shorten. The antenna should not come into contact with other metal parts otherwise it will reduce the effect.
4. The motor must be protected from direct moisture influences.



Functions DC-415

Stop

Open A --- Close A
 Open B --- Close B
 Channel*

(* Change channel works only with DC-416)



P1
P2



This is a 2-channel transmitter, two P2 keys for each one channel.

Works with all BREL transmitters:



Technical data of the motor

- | | |
|-------------------------------------|-----------------|
| • Motor Voltage: | 230V |
| • Power: | 45 Watt |
| • Speed: | 12 rpm |
| • Max. curtain weight: | 40 kg |
| • Ampèrage | 0.23 A |
| • Max. duration: | 4 min. |
| • Moisture and dust: | IP40 |
| • Working temperature of the motor: | |
| ○ Normal use: | -10°C tot +40°C |
| ○ Heavy use: | -20°C tot +70°C |

Type MG45



Functions

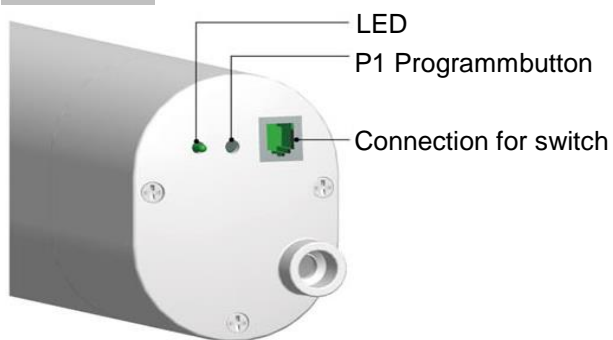

Reach

L1 = 100 meter

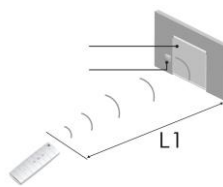

L2 = 25 meter

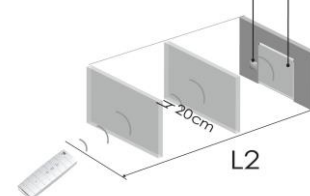

Wiring chart

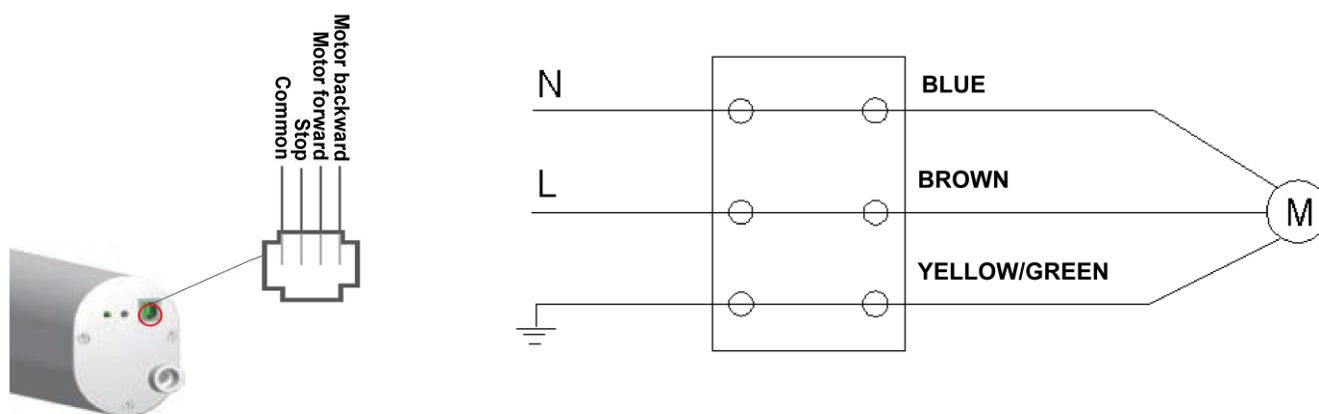

Installation motor and rail

Attach the rail to the wall / ceiling.

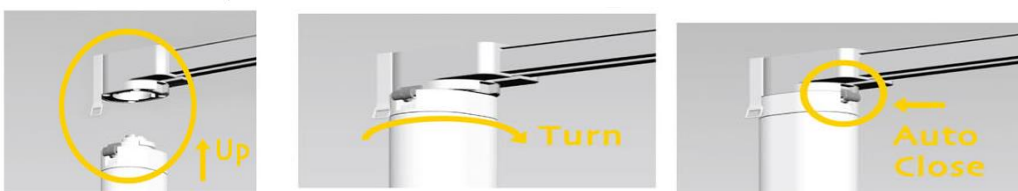

If the motor don't want to click easily, turn the gear wheel a bit and try again.

Step 1 Setting up the first channel



Press 1x on the P1 button until the LED flashes.

Press 2x on the P2 button.

Press the close button.

The LED flashes 5x.

Press the close or open button. Left or right determines the direction of rotation.

Step 2 Setting with another direction of rotation

Variant A If the rotation direction is good, skip step 2 and continue with step 3.

1x P1



Press P1 and hold until LED flashes.

2x P2



Press 2x on the P2 button.

1x →



Press 1x open.

5x LED



LED flashes 5x.

You can now continue with setting the end position.

Variant B

1x P1



Press P1 and hold until LED flashes.

→ The direction of rotation has changed.

Step 3 Setting the end positions

1x ←



Press 1x close.

|←



Curtain closes completely. Stops hard at the end.

1x →



Press 1x open.

→|



Curtain opens completely. Stops hard at the end.

If the end positions are set with a hard stop, the curtain will stop 1 cm before the end in the future.

To remove / change the end position go to Option C.

Step 4 Set or change preset position

If you press the Stop button longer than 3 sec., the motor will move to the preset position from any position.

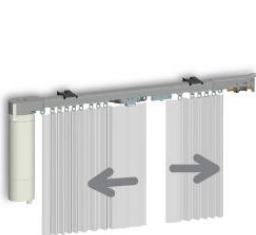

Press 1x the P2 button.

1x P2



Press 1x stop button. The LED flashes.

1x STOP



Press 1x stop button. The LED flashes.

1x STOP



The position has now changed.

→ OK

In order to remove / change the preset position, the same procedure must be repeated at the position of the preset position.

Option A Delete transmitter

Deleting the transmitter can be done in three ways:

1. When setting up the first channel also the limit setup will be removed.

2.



Press P1 button until the LED flashes 3x and blinked 1x.

3.

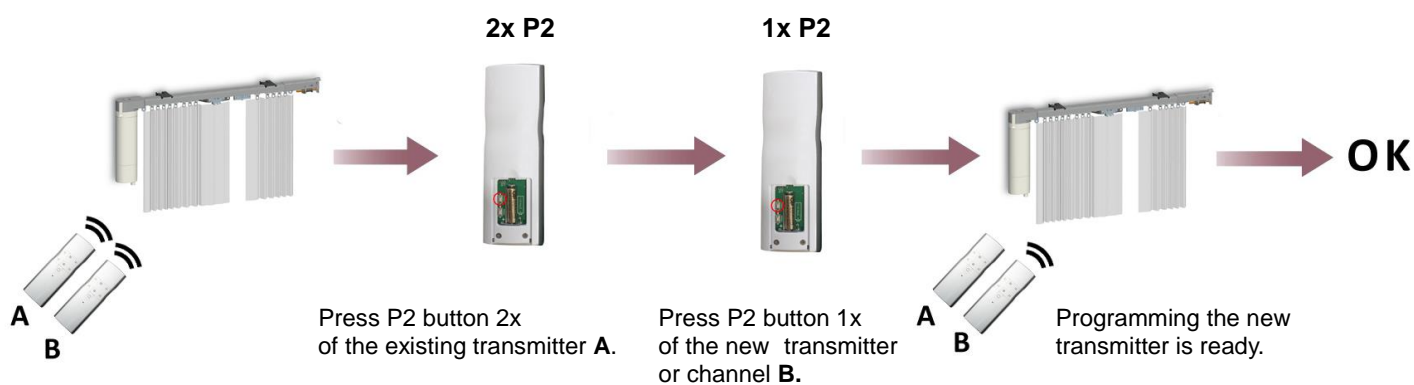

Press P2 button 1x. Press stop button. Press P2 button 1x.

Option B Teaching multiple transmitters (Maximum of 20 transmitters per receiver)

To delete one channel, you must repeat the above operation.

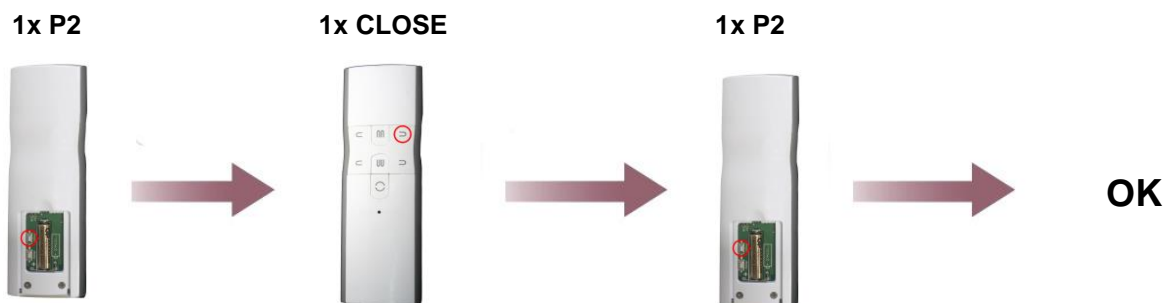
Optie C Eindposities verwijderen en nieuwe laten inleren.

Press 1x P2.

Press 1x close button.

Press 1x P2.

LED flashes 5x for confirmation.

Then let the curtain open and close. This person then looks for the new final positions himself.